

**CONTRACTOR INSURANCES:**

1. INSURANCE: CONTRACTOR(S) SHALL PROVIDE PROOF OF INSURANCE, INCLUDING COMMERCIAL GENERAL LIABILITY, WORKMEN'S COMPENSATION AND AUTOMOBILE LIABILITY. MINIMUM LIMITS SHALL BE AS FOLLOWS:		
COMMERCIAL GENERAL LIABILITY	GENERAL AGGREGATE	\$ 1,000,000.00
	PRODUCTS - COMP / OP AGGREGATE	\$ 1,000,000.00
	EACH OCCURRENCE	\$ 100,000.00
	FIRE DAMAGE (ANY ONE FIRE)	\$ 5,000,000.00
	MED. EXPENSE (ANY ONE PERSON)	\$ 250,000.00
AUTOMOBILE LIABILITY	SINGLE COMBINED LIMIT	STATUTORY LIMITS
WORKMAN'S COMPENSATION		STATUTORY LIMITS
GENERAL "UMBRELLA"		\$ 2,000,000.00

- BEFORE CONTRACTOR(S) DOES ANY WORK ON SITE, CERTIFICATES SHALL BE PROVIDED DIRECT FROM THE CONTRACTOR'S AGENT, VERIFYING THAT OWNER AND ARCHITECT ARE NAMED AS "ADDITIONAL NAMED INSURED" ON CONTRACTOR'S LIABILITY AND UMBRELLA POLICIES.
- OWNER AND ARCHITECT SHALL BE GIVEN 30 DAYS NOTICE BEFORE ANY POLICIES EXPIRE. CONTRACTOR(S) SHALL MAINTAIN THIS REQUIREMENT FOR A MIN OF 365 DAYS AFTER FINAL PAYMENT. CERTIFICATES EVIDENCING SUCH COVERAGE AND INCLUSION OF THE OWNER AND ARCHITECT SHALL BE PROVIDED TO BOTH.

**RESIDENTIAL CODES**

- CONTRACTOR(S) SHALL COMMUNICATE WITH THE MUNICIPALITY TO VERIFY REQUIRED TYPES AND FREQUENCY OF INSPECTIONS, AND SHALL SECURE ALL PERMITS, LICENSES, APPROVALS, AND INSPECTIONS REQUIRED DURING THE PROGRESS OF THE WORK.
- ALL CONTRACTORS AND TRADESMEN ARE EXPECTED TO BE CURRENT WITH REGULATORY CODES AND HAVE COPIES ON SITE FOR REFERENCE AS REQUIRED. TO OBTAIN: INTERNATIONAL CODE COUNCIL, PUBLICATIONS, 4091 WEST FLOSSMOOR ROAD, COUNTRY CLUB HILLS, IL 60478-8795, 888-422-7233.
- A117.1-2012, ACCESSIBLE & USABLE BLDG'S & FACILITIES
- INTERNATIONAL RESIDENTIAL CODE, 2009 THE IRC/2009 MAY BE KNOWN AND CITED AS THE ONE- AND TWO-FAMILY DWELLING SUB CODE.
- ICC ELECTRICAL CODE, 2009 (UTILIZES NATIONAL ELECTRIC CODE STANDARDS)
- INTERNATIONAL ENERGY CONSERVATION CODE, 2012

**SITE SAFETY:**

- CONSTRUCTION DEBRIS: ALL CONSTRUCTION MATERIAL DEBRIS SHALL BE REMOVED FROM THE SITE AND DISPOSED OF BY THE GC. DAILY CLEANUP SHALL BE IN CONTAINERS OR DUMPSTERS MAINTAINED BY THE GC. DO NOT BURY OR BURN ANY MATERIAL AT THE SITE. REMEMBER THERE IS A FAMILY IN RESIDENCE ON THE SITE.
- SITE SAFETY: THE GENERAL CONTRACTOR GAINS COMPENSATION FOR ORGANIZING AND EXECUTING THE WORK AT THE SITE. THUS, THE GC IS RESPONSIBLE FOR ALL SITE SAFETY PRECAUTIONS AND ALL SITE SUPERVISION.

DOOR SCHEDULE					
MARK	ROOM	SIZE	LATCH	FUNCTION	NOTES
1	LIVING	EXIST	CYL	ENTRY	EXIST., NO CHANGES
2	BACK ENTRY	60" W. SLIDING PATIO	DOOR MFG.	ENTRY	BASE BID: INTEGRITY, ALL-ULTEX, IFSFD066RHAND
3	TO BASEMENT	28"	CYL	ENTRY	INSULATED STEEL, EMBOSD 6-PNL, GASKETED, ENTRY SYSTEM
4	BED 2	30"	CYL	PRIVACY	
5	OFFICE	30"	CYL	PRIVACY	
6	HALL	32"	CYL	PRIVACY	
7	HVAC CL.	24" / FIELD	CYL	PASSAGE	
8	HERS CL.	30"	CYL	PASSAGE	
9	HIS CL.	30"	CYL	PASSAGE	
10	HALL CL.	18"	CYL	PASSAGE	
11	MASTER BED	36"	POCKET	PRIVACY	POCKET DOOR HARDWARE
12	MASTER BATH	30"	CYL	PRIVACY	
13	MASTER BATH	24"	CYL	PRIVACY	
14	BED 2 CL.	30"	CYL	PASSAGE	

- BASE BID HARDWARE FINISH "BRUSHED CHROME"
- ALL DOORS TO HAVE 1-1/2 PAIR (3) OF HINGES, HOLLOW OR SOLID
- LATCH-SET BASE BID: SCH-LAGE "A-LINE", DESIGN: RECOMMEND AN "ADA COMPLIANT" SIMPLE MODERN LEVER SET. OWNER TO SELECT
- INTERIOR DOORS BASE BID: 1 3/8" HOLLOW CORE, 6-PANEL EMBOSSED, PRE-HUNG, PAINT GRADE, PRE-BORED FOR HARDWARE

**LEAD PAINT CERTIFICATION**

- IF THE STRUCTURE BEING DISTURBED EXISTED BEFORE 1978, IT MAY CONTAIN PRODUCTS, PAINT AND PLUMBING, WITH A HIGH LEAD HAZARD. THE HOME OWNER AND ALL CONTRACTOR(S) UNDERSTAND THERE ARE CERTAIN "BEST PRACTICES" WHICH MUST BE FOLLOWED TO PROTECT THE PUBLIC HEALTH WELFARE AND SAFETY. SEE PUBLIC INFORMATION.
- CONTRACTOR(S) SHALL PRESENT TO THE OWNER A CERTIFICATION CHECKLIST DEMONSTRATING THEIR ACTIONS TO BE COMPLIANT WITH REGULATORY AGENCIES AND HOW EACH CONTRACTOR AND/OR SUB-CONTRACTOR WILL DEMONSTRATE THOSE BEST PRACTICES DURING THE WORK.

**FIELD OFFICE AND SITE DOCUMENTS**

- WHENEVER THE WORK IS IN PROGRESS THE FIELD OFFICE SHALL BE ACCESSIBLE TO THE OWNER & CONSTRUCTION TEAM AND SHALL CONTAIN THE MOST UP TO DATE DOCUMENTS, SUBMITTALS, MATERIAL SELECTIONS, AND SHOP DRAWINGS. THE PROJECT DOCUMENTS SHALL BE ORGANIZED, COMPLETE, AND CLEAN.
- AS-BUILT DRAWINGS: THE CONTRACTOR SHALL MAINTAIN ONE RECORD SET OF DOCUMENTS WITH ALL AS-BUILT INFORMATION AND CHANGES MARKED UP IN RED, WHICH SHOW ANY DIFFERENCES FROM THE ORIGINAL DOCUMENTS. AT COMPLETION OF THE WORK, CONTRACTOR SHALL MAKE THREE (3) XEROX SETS. THESE "AS-BUILT" SETS SHALL BE DISTRIBUTED: 1 SET TO OWNER, 1 SET TO ARCHITECT, 1 SET TO THE GC'S FILE.

**QUALITY AND GUARANTEES:**

- QUALITY OF WORKMANSHIP AND MATERIALS: THE CONTRACTOR(S) AGREES HE SHALL ENGAGE WORKMEN KNOWLEDGEABLE IN THEIR RESPECTIVE TRADES WHOSE WORK SHALL COMPLY WITH THE HIGHEST STANDARDS OF THEIR RESPECTIVE TRADE ASSOCIATIONS.
- IT IS UNDERSTOOD THE ARCHITECT HAS NOT DETAILED OR SPECIFIED ALL ASPECTS OF THE WORK, WHICH ARE A "COMMONLY UNDERSTOOD CONSTRUCTION PRACTICE". IF INTERPRETATIONS OR CLARIFICATIONS ARE REQUIRED, THE CONTRACTOR(S) SHALL SECURE SUCH INFORMATION FROM THE ARCHITECT OR THE OWNER BEFORE PROCEEDING.
- PROJECT GUARANTEE: THE CONTRACTOR(S) AND ALL SUBCONTRACTORS UNDER HIS RESPONSIBILITY SHALL GUARANTEE ALL WORKMANSHIP AND INSTALLED MATERIAL FOR A MINIMUM OF ONE YEAR AFTER THE OWNER ACCEPTS THE WORK FOR THE USE INTENDED. WITHIN THE ONE-YEAR GUARANTEE PERIOD, THE CONTRACTOR SHALL REMAIN RESPONSIBLE TO THE OWNER FOR PROMPT AND DILIGENT REPAIR OR REPLACEMENT OF FAILED MATERIALS AND OR WORKMANSHIP. COMPONENTS, EQUIPMENT AND INSTALLATIONS THAT ARE PROTECTED WITH MANUFACTURER'S WARRANTIES SHALL BE IDENTIFIED TO THE OWNER. THE OWNER SHALL RECEIVE RECEIPTS AND VALIDATED WARRANTY REGISTRATIONS RECORDING THESE PROTECTIONS. TITLE TO ALL EQUIPMENT AND COMPONENTS WITH WARRANTIES SHALL BE MADE IN THE OWNER'S NAME.

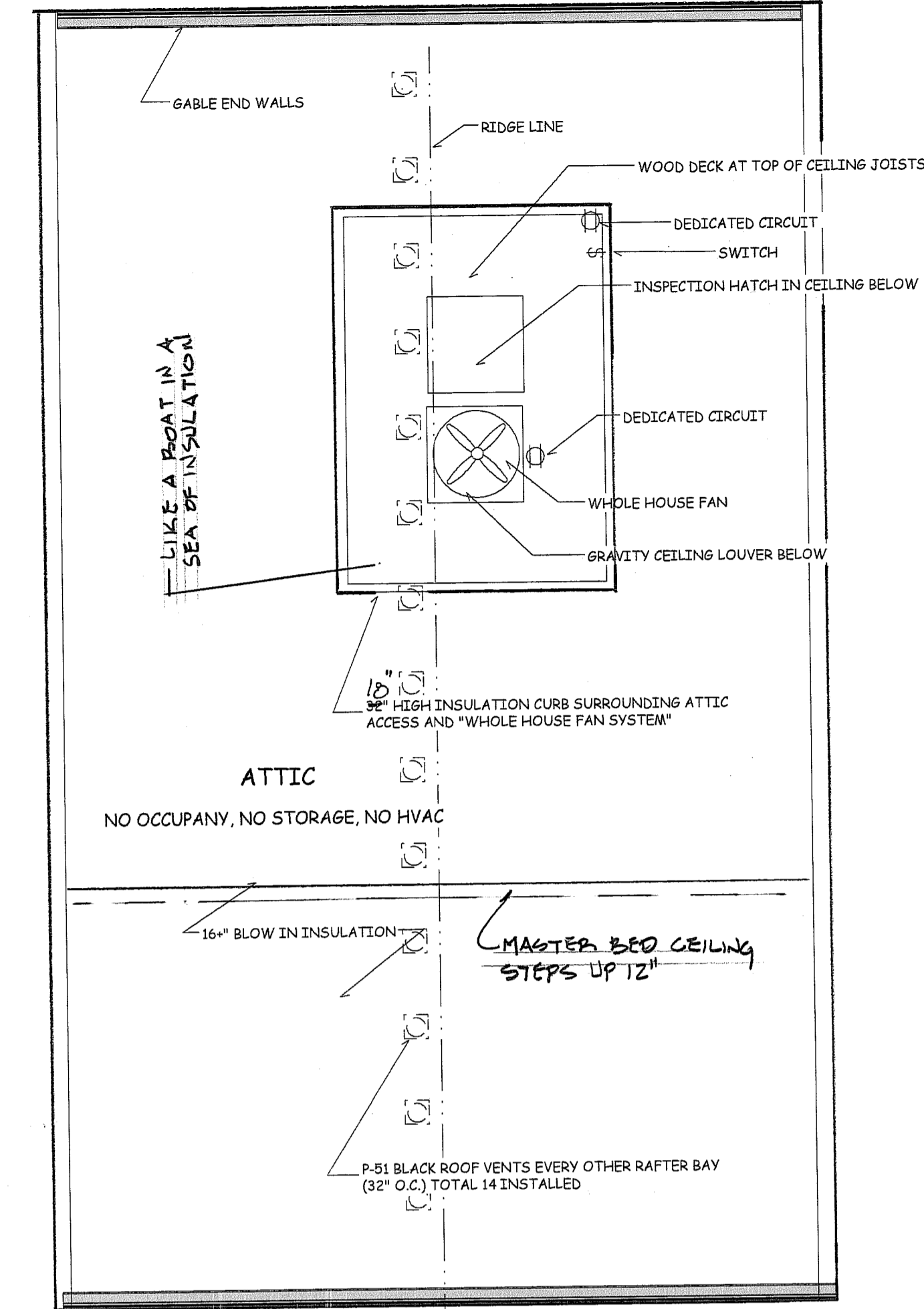

1 3 PROPOSED ATTIC PLAN SCALE 1/4" = 1'-0"

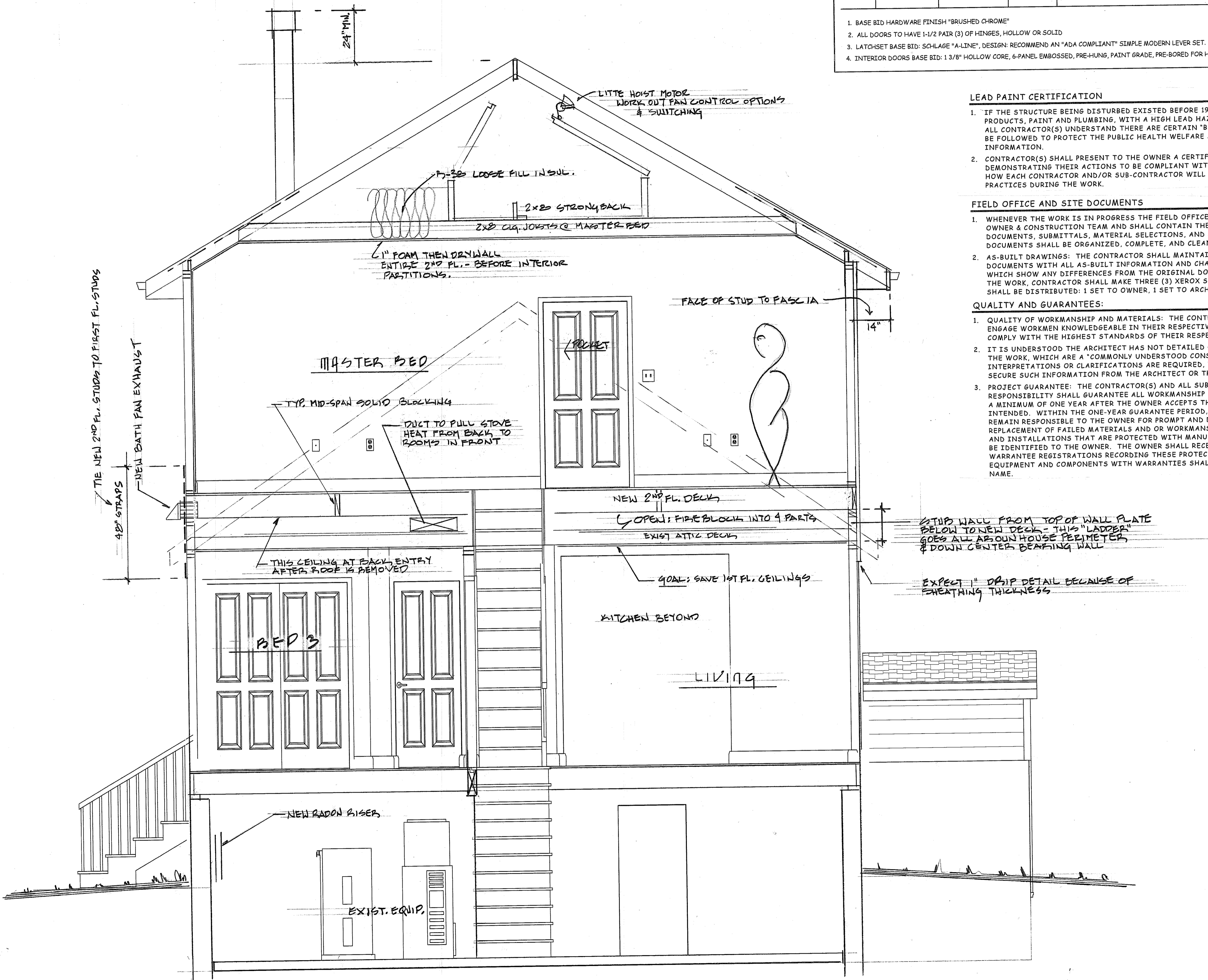

CONSTRUCTION SECTION SIDE to SIDE SCALE 1/2" = 1'-0"

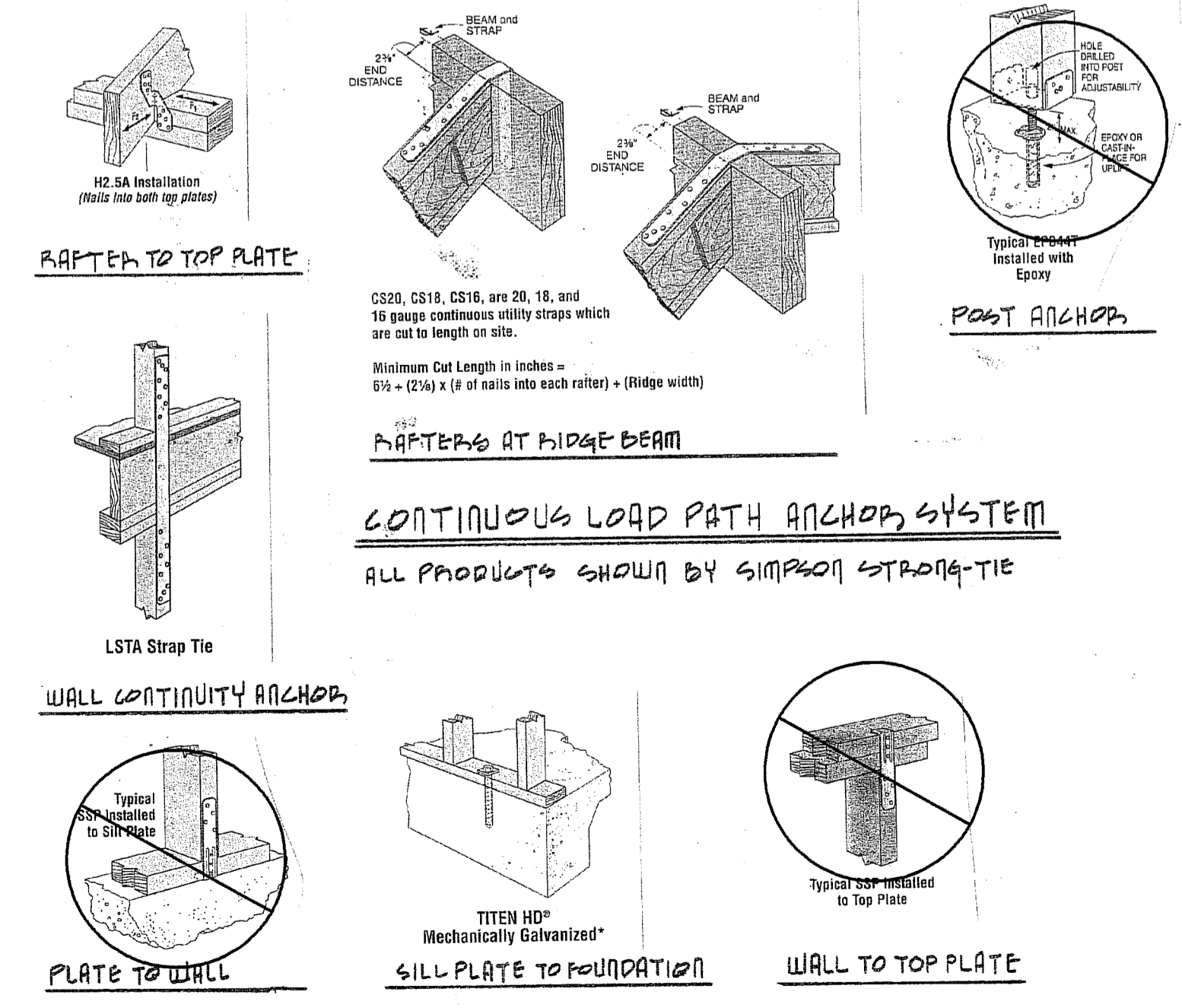

CONTINUOUS LOAD PATH ANCHORAGE

DATE	REVISION DESCRIPTION
07/18/2016	
07/04/2016	

ONLY VALID FOR PERMITS w/ EMBOSSED SEAL & ORIGINAL SIGNATURE IN "RED"

Eric C. Van Reed, Architect  
 PA-FA008011X  
**Creative Design Associates, Inc.**  
 ARCHITECTURE • INTERIORS • SITE & SPACE PLANNING  
 350 Callowhill Road  
 Chalfont, PA 18914  
 Voice: 215.872.1155  
 www.creative-design.com

1826 Meadowbrook Road  
 SECOND FLOOR ADDITION  
 Lower Southampton Township, Bucks County, Pennsylvania